

PLAN No 2012
FOR
THE IMPROVEMENT
RIALTO AVENUE
BETWEEN
WATERMAN AVENUE
AND
ARROWHEAD AVENUE
IN THE
CITY OF SAN BERNARDINO
CALIFORNIA.
MAY 1952

PLAN ADOPTED JUNE 30, 1952

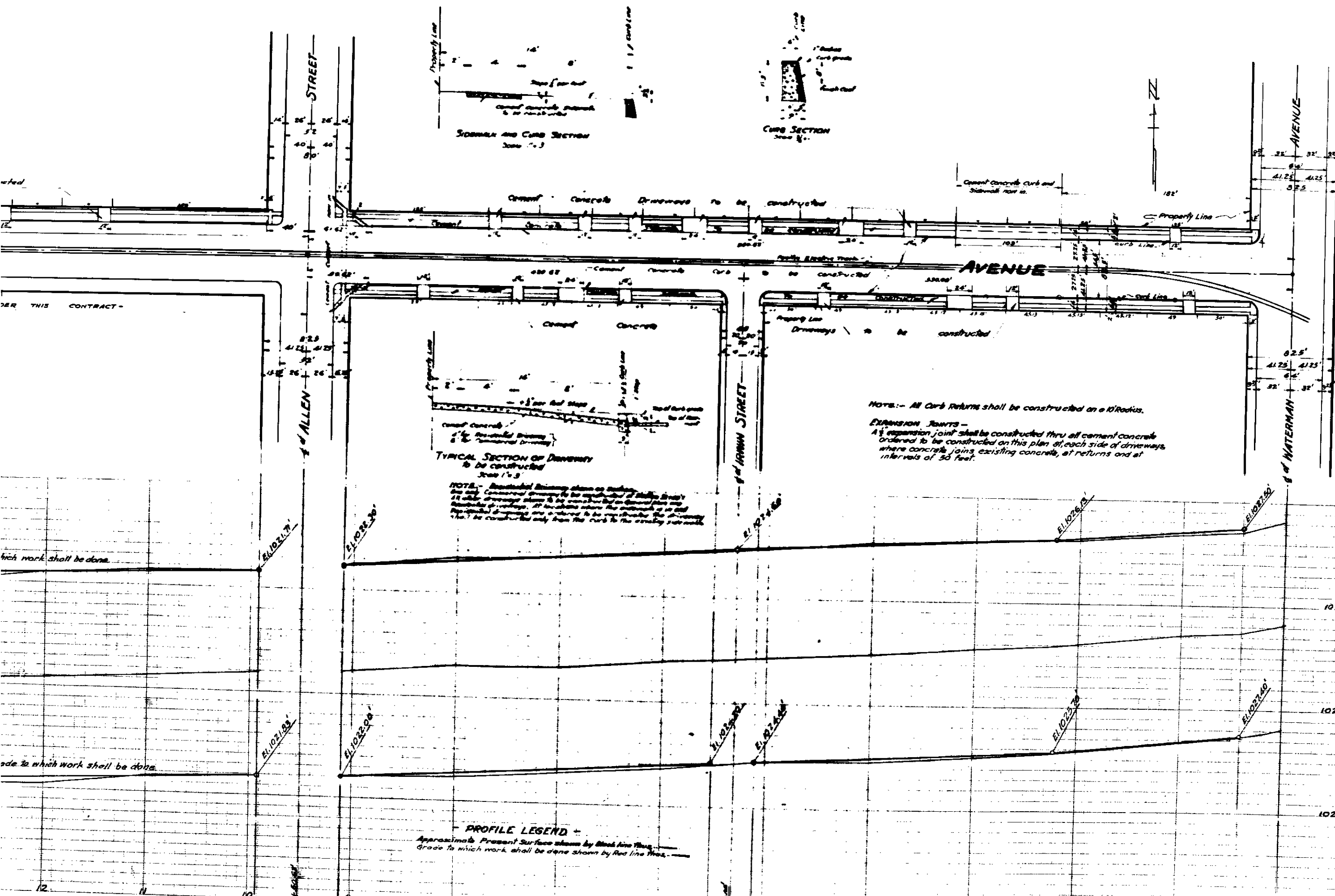

SIDEWALK AND CURB SECTION
Scale 1" = 3'

CURB SECTION
Scale 1" = 3'

TYPICAL SECTION OF DRIVEWAY
to be constructed
Scale 1" = 3'

NOTE - Residential Driveway shown as existing. Commercial Driveway to be constructed of 4" thick concrete. All driveways shall be constructed on ground plan and finished to existing grade. All driveways shall be constructed to existing grade. All driveways shall be constructed to existing grade.

NOTE: - All Curb Returns shall be constructed on a 10' Radius.

EXPANSION JOINTS - A 1/2" expansion joint shall be constructed thru all cement concrete ordered to be constructed on this plan at each side of driveways, where concrete joins existing concrete, at returns and at intervals of 50 feet.

- LEGEND -

- 4" in means inch or inches
- ft means foot or feet
- 10' means number
- C means center line
- 11 means elevation
- Cement Concrete Curb to be constructed shown on plan thus: [Symbol]
- Cement Concrete Sidewalk to be constructed shown on plan thus: [Symbol]
- 4" Cement Concrete Residential Driveway to be constructed shown on plan thus: [Symbol]
- 6" Cement Concrete (Commercial) Driveway to be constructed shown on plan thus: [Symbol]

- TITLE TO STREET -

Title to RIALTO AVENUE (formerly by dedication by Map of Rancho San Bernardino in Book 7 of Maps page 2 records of the San Bernardino, California.

GRADE RESOLUTIONS

Grade of Rialto Avenue was established by Ordinance No. 20, dated 4/19/1895, Ordinance No. 854 dated 10/12/21 and Ordinance No. 1360 dated 12/13/36 of the City of San Bernardino, California.

- DATUM -

All elevations shown in "Red ink" are in feet and are above a plane which is 100.00 feet below the City Bench Mark established by Ordinance No. 583 of the City of San Bernardino, California.

PROFILE LEGEND

Approximate Present Surface shown by Black line thus: [Symbol]
Grade to which work shall be done shown by Red line thus: [Symbol]